

Designed by **ROBOTIME**
www.robotime.com
MADE IN CHINA

49.2TGB05.100

Rolife

FALLING SAKURA

-TGB05-

3D CREATIVE BOOKENDS

Pictures for reference only. Please subject to our existing products.



⚠ WARNING

- The product requires 2"AAA/LR03/AM4 1.5V" batteries (batteries for self-preparation).
- Before loading or removing batteries, please loosen screws on the cover of the battery box with the screwdriver first.
- Non-rechargeable batteries are not to be recharged.
- Rechargeable batteries are only to be charged under adult supervision.
- Rechargeable batteries are to be removed from the toy before being charged.
- Different types of batteries or new and used batteries are not to be mixed.
- Batteries are to be inserted with the correct polarity (+ and -).
- Remove the exhausted battery in time.
- The power supply terminal cannot be short circuited.
- Do not connect the wire to a mains outlet.
- The product is not to be connected to more than the recommended number of power supplies.
- Check each part before assembly. If the part is damaged, fix it well before assembly.
- Please keep the product away from substances flammable and humid environments to prevent damage.
- The instruction must be retained since it contains important information.

⚠ ATTENTION

- Some small parts and electronic components are included, and children must assemble under the guidance and supervision of adults in case of swallowing by mistake or choking.
- Some auxiliary tools are required to assemble. Please choose reasonably to avoid injury.
- Please read the instructions carefully before assembly to confirm that the parts are not damaged or missing.
- Please carefully cut the parts and make sure they are firmly pasted when using glue.
- Please install the electronic components correctly and test whether the circuit is normal after completion.
- Please don't clean this product with chemical cleaners: alcohol, ammonia water, glass cleaner, etc.
- Please clean the product with clean soft cloth, and sand the board burr lightly with sandpaper.
- Glue is a gift not for sale. If it becomes dry or excessive glue due to time or environmental problems, you can use your own glue to assemble.

★ Due to customs policy in international shipping, the batteries, glue or pigment may not be included. Please prepare them yourself.

Equipped with 3 controllable lights

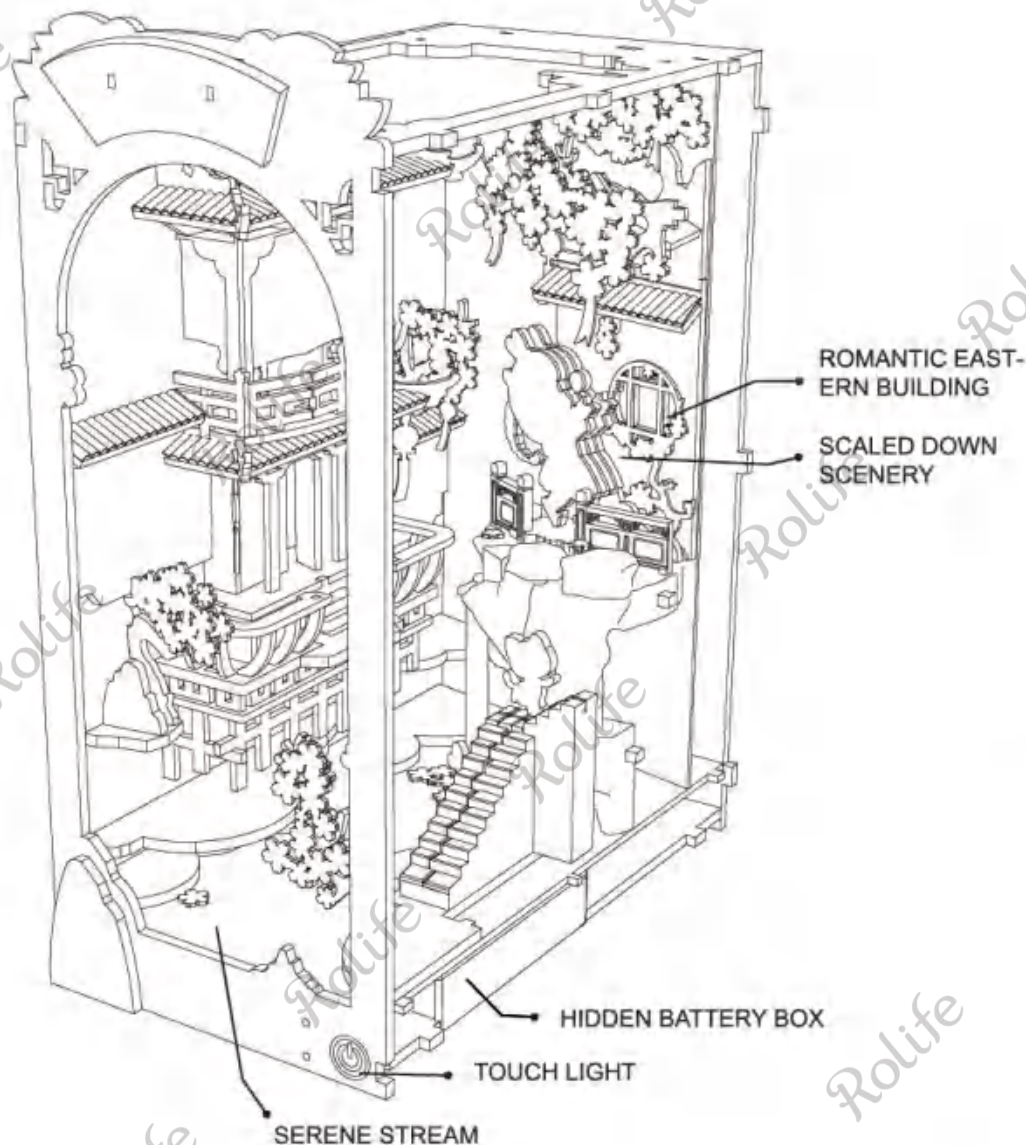

Special attention in assembly



Assemble the parts symmetrically



Perspective changed



Printed side



Blank side

1 Step 1

2 Step 2

● Q&A

Q1: What should I do if some of the parts are too tight to assemble or the edges of them are not smooth?

A1: You can polish the cutting points with the sandpaper to enhance its accuracy and polish the burrs to ensure your safety.

Q2: What should I do when the parts are loose after being dismantled several times?

A2: You can dab some glue on inserting positions.

Q3: When I turn on the light but it does not work, what should I do then?

A3: 1. Figure out whether the main switch of cell box is on.
2. Make sure the wires are connected in a proper way, wires of the same color should be connect together.
3. Check whether the touch board aligns with the wooden board, the gap between them will make switch not sensitive or even fail to work.

1

Before assembly, please read above Q&A carefully. Before using the glue, please shake well and remove the inside lid.

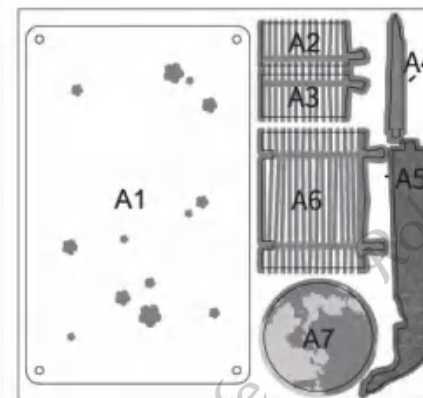

Parts numbers on Board A

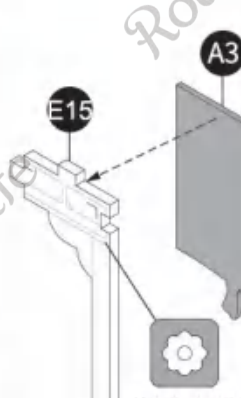

Apply a dab of glue on dotted line areas. Align and glue the part with the position line.

Printed side

Peel off the film on surface. Fix it with glue.

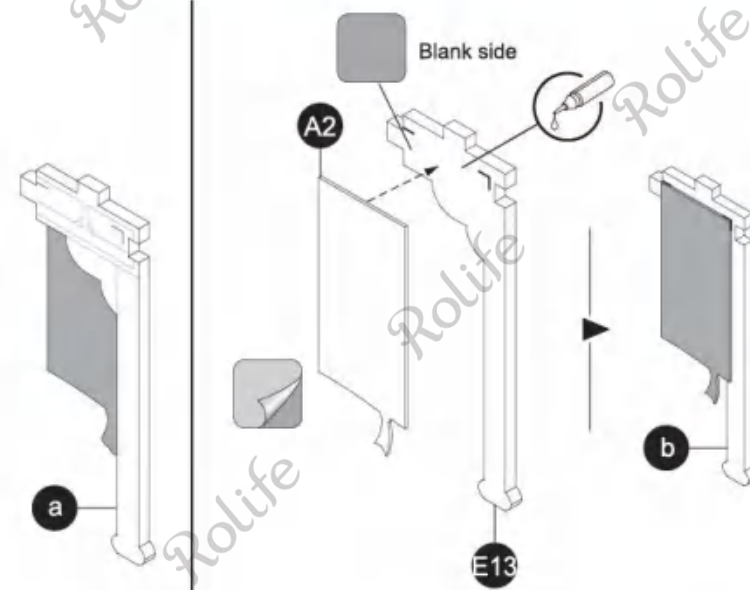

2

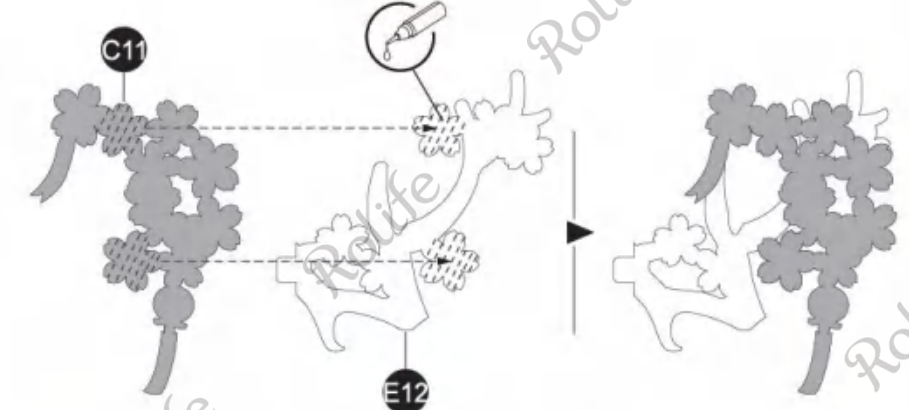
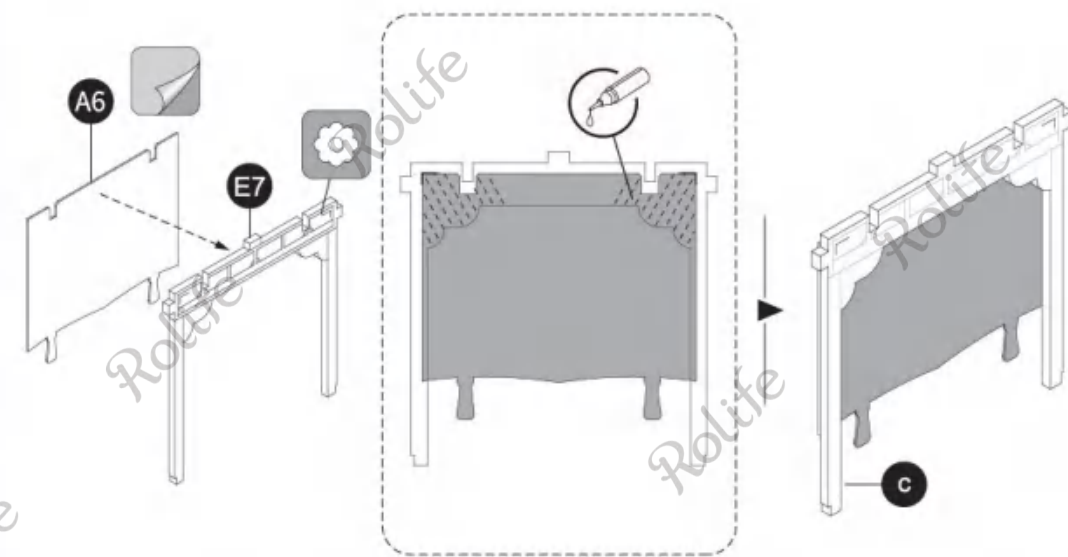

Align and glue dashed lines petals of C11 with those of E12 as shown.

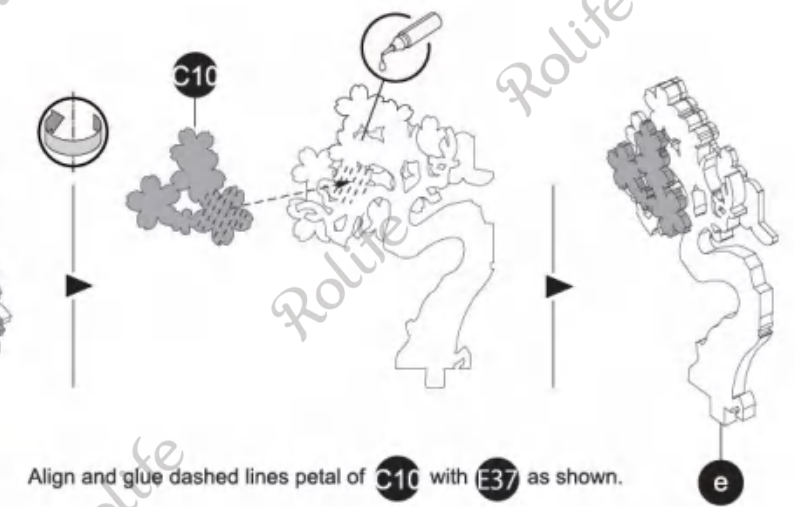

Align and glue dashed lines petal of C10 with E37 as shown.

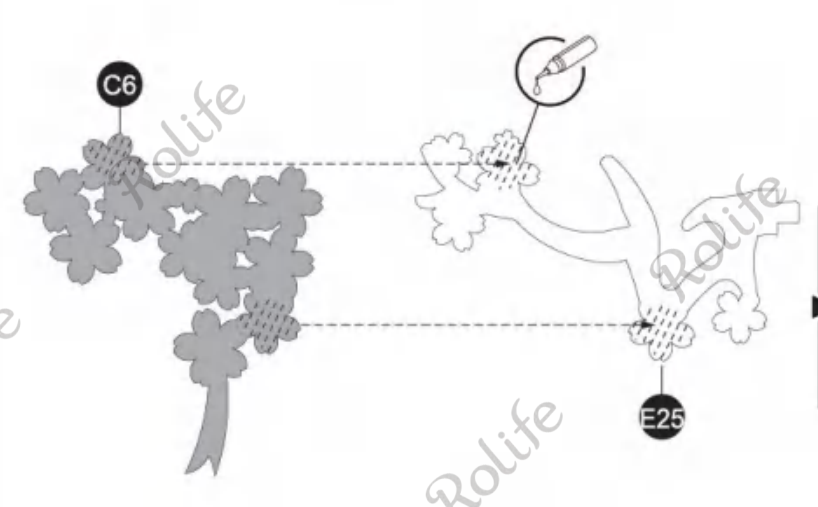

Align and glue dashed lines petal of C6 with E25 as shown.

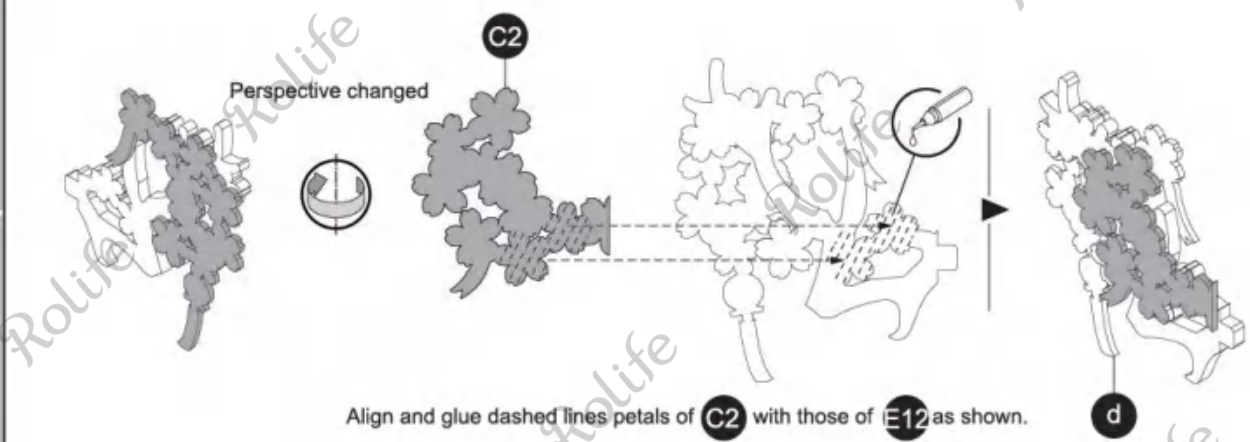

Align and glue dashed lines petals of C2 with those of E12 as shown.

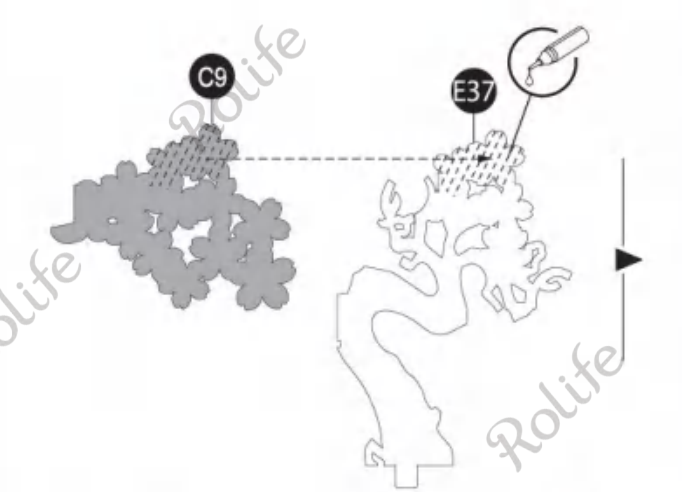

Align and glue dashed lines petals of C9 with those of E37 as shown.

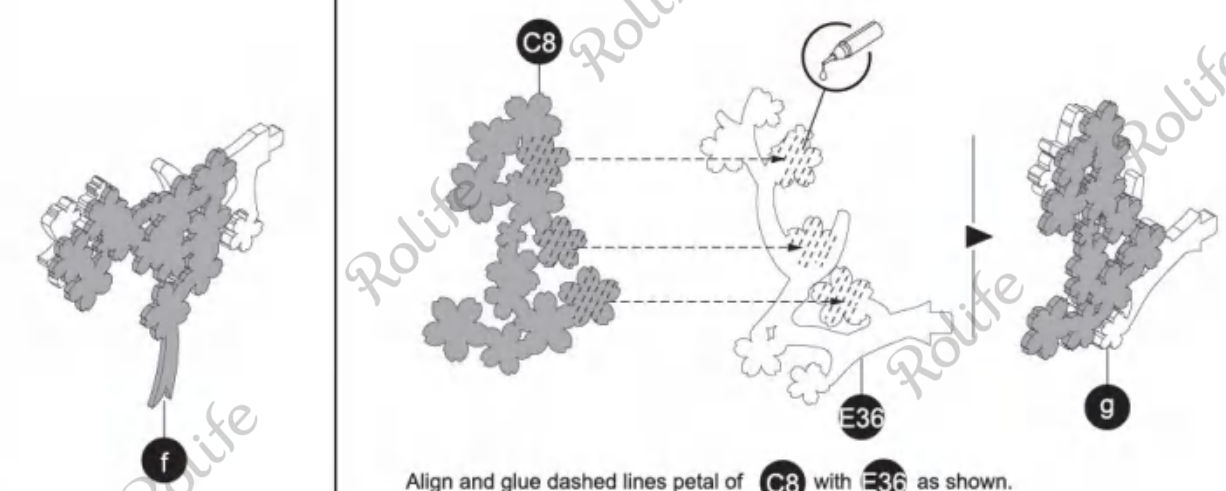

Align and glue dashed lines petal of C8 with E36 as shown.

3

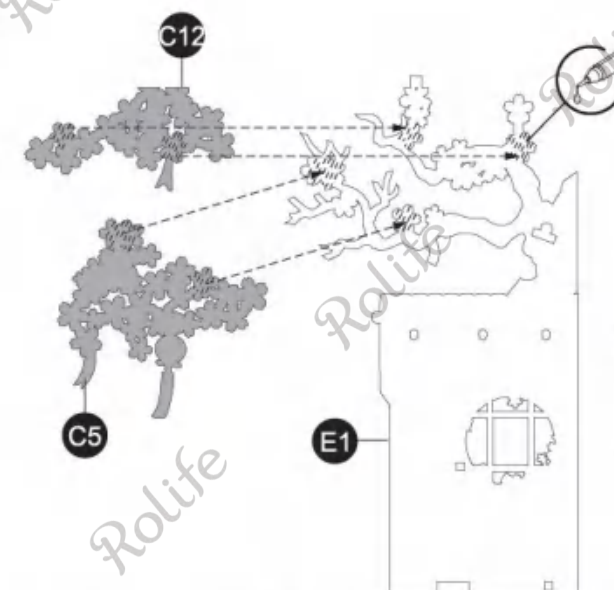

Align and glue dashed lines petal of C5 and C12 with E1 as shown.

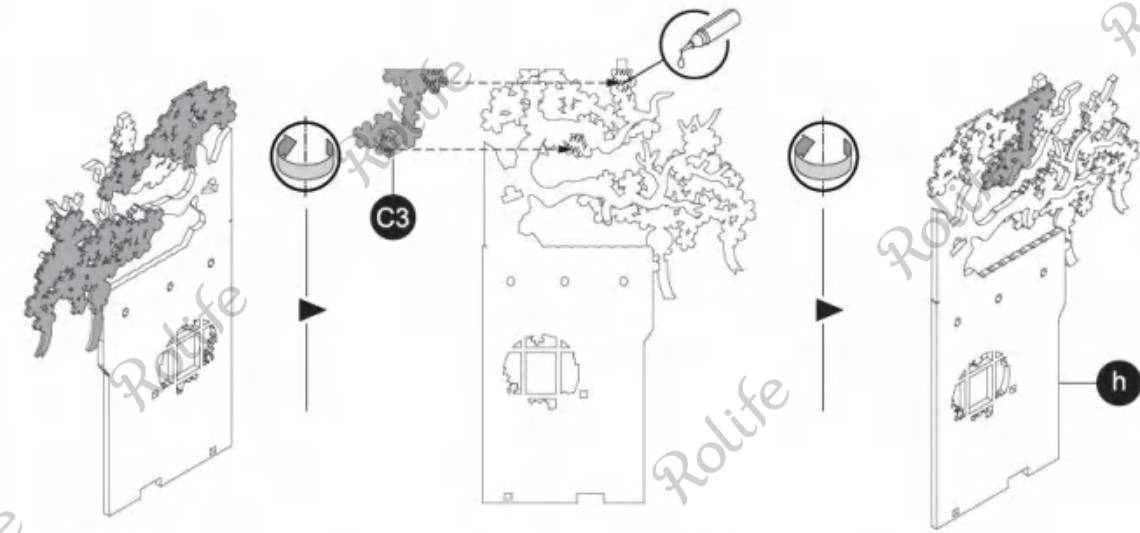

Align and glue dashed lines petals of **C3** with dashed areas of **E1** as shown.

Accessories can be found in the white blister box in the package.

Apply a dab of glue on dashed line areas.

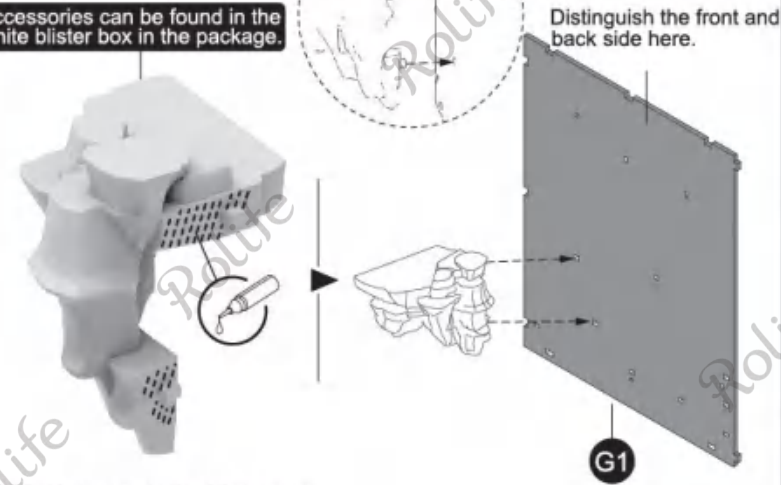

Distinguish the front and back side here.

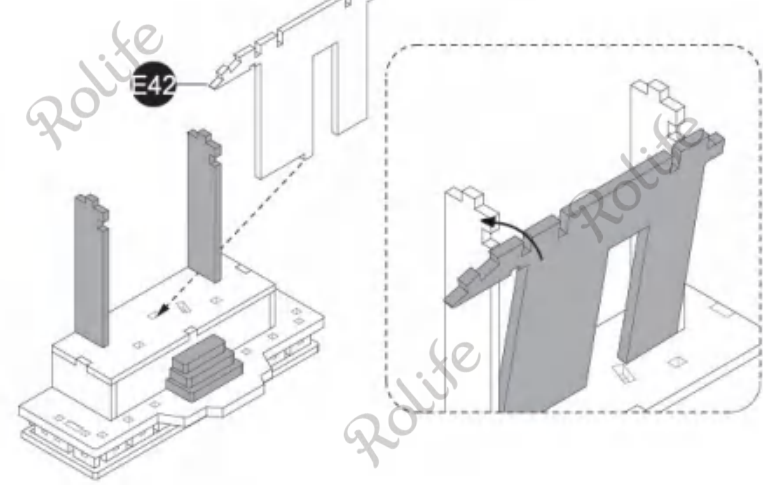
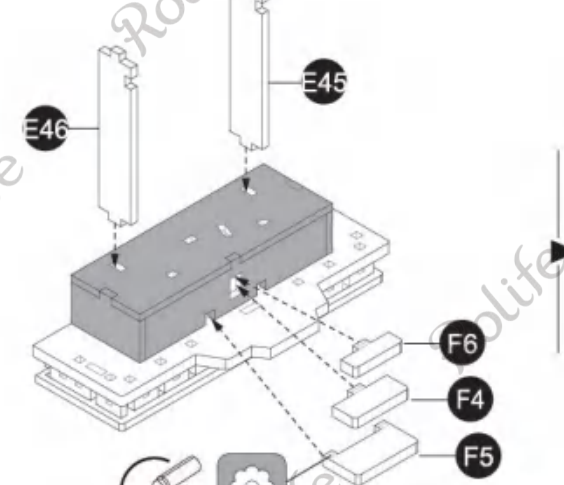
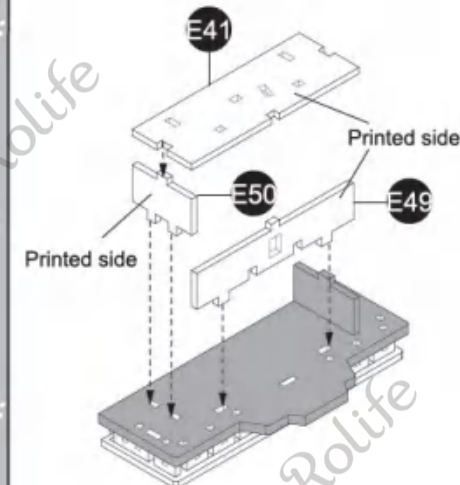

5

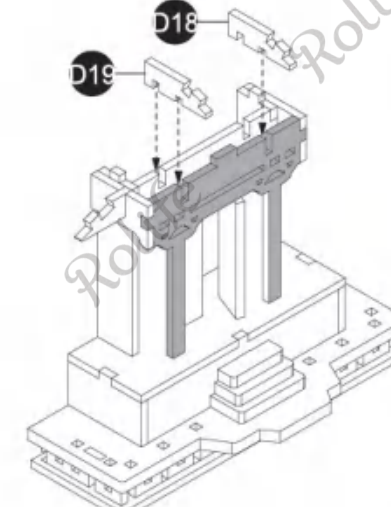
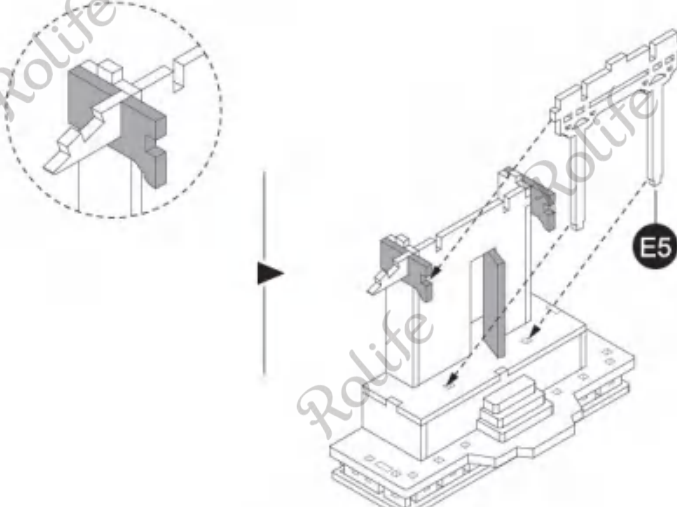
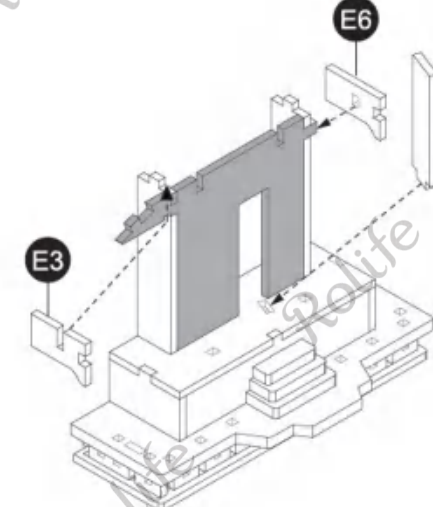
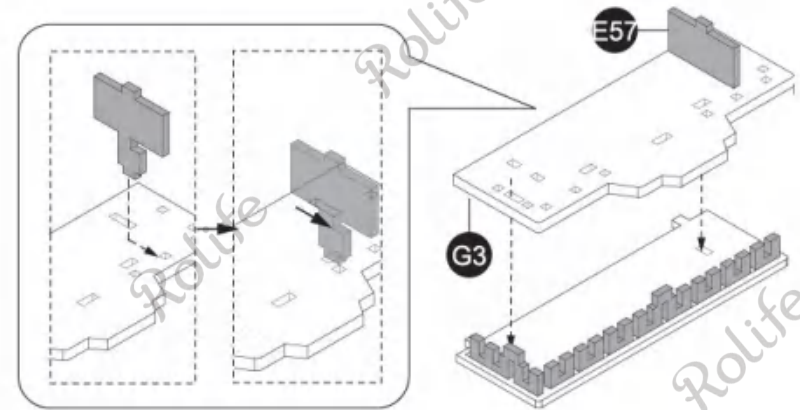
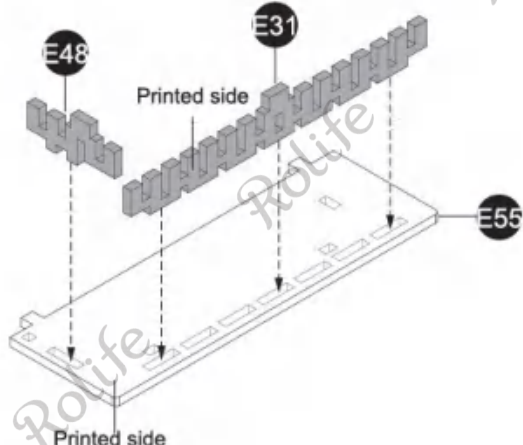
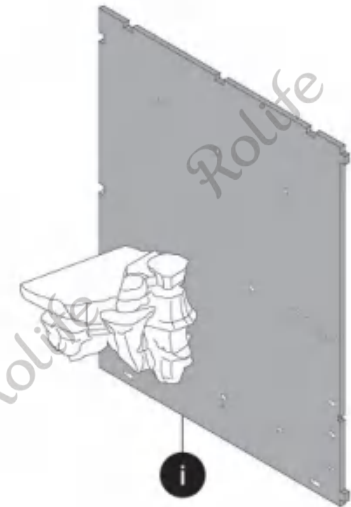

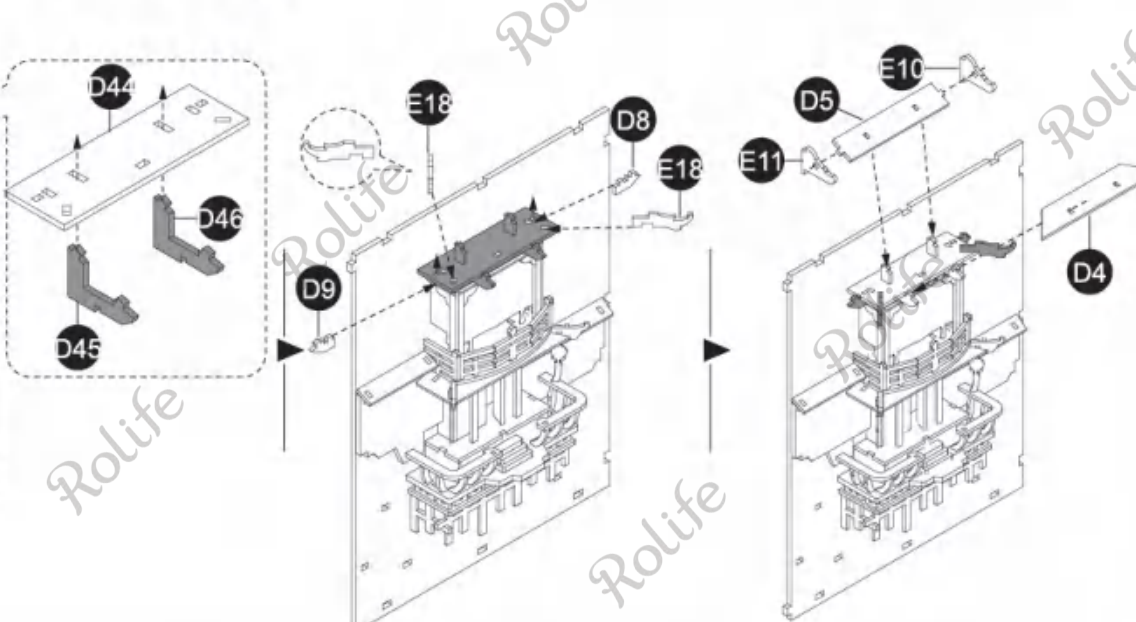
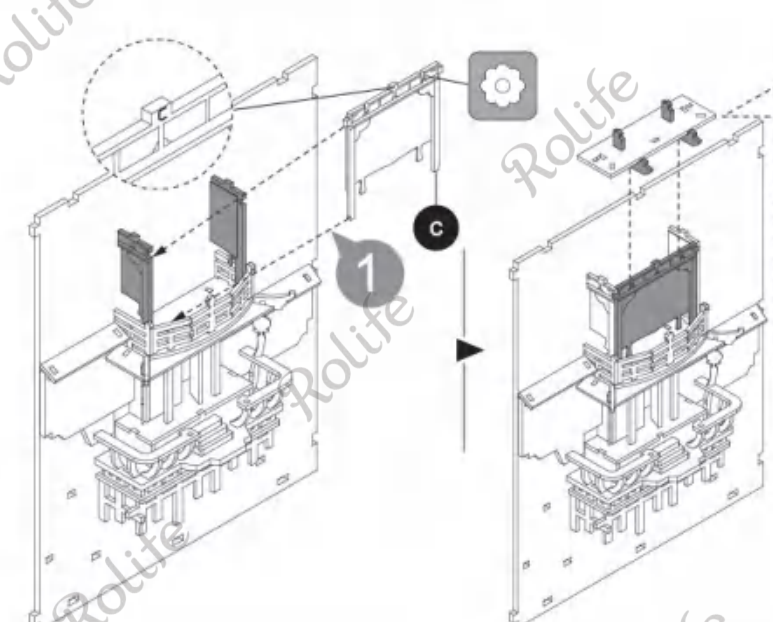
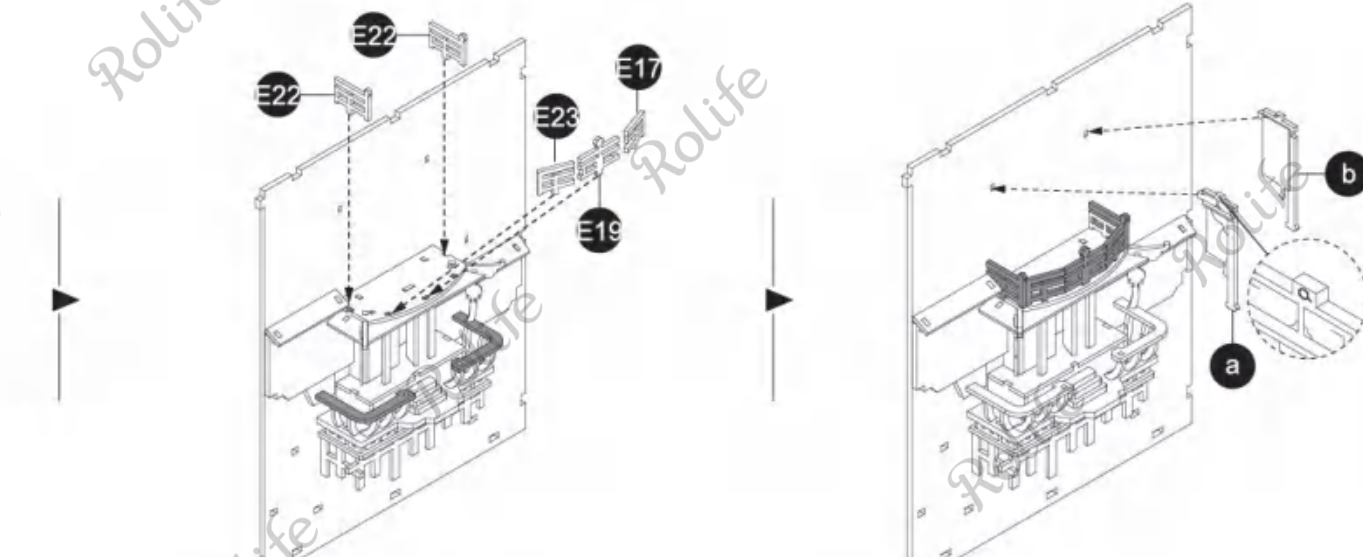
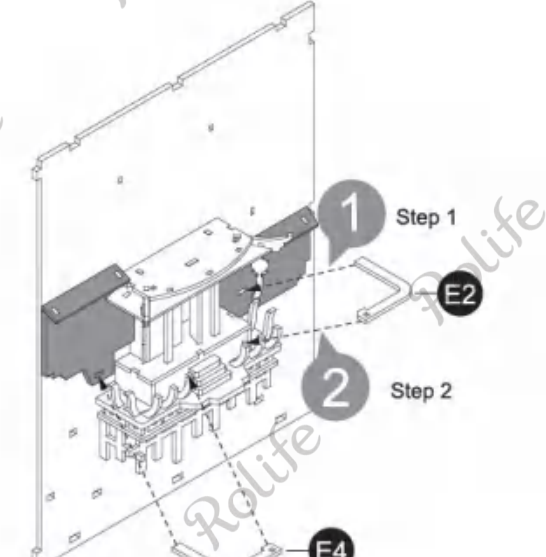
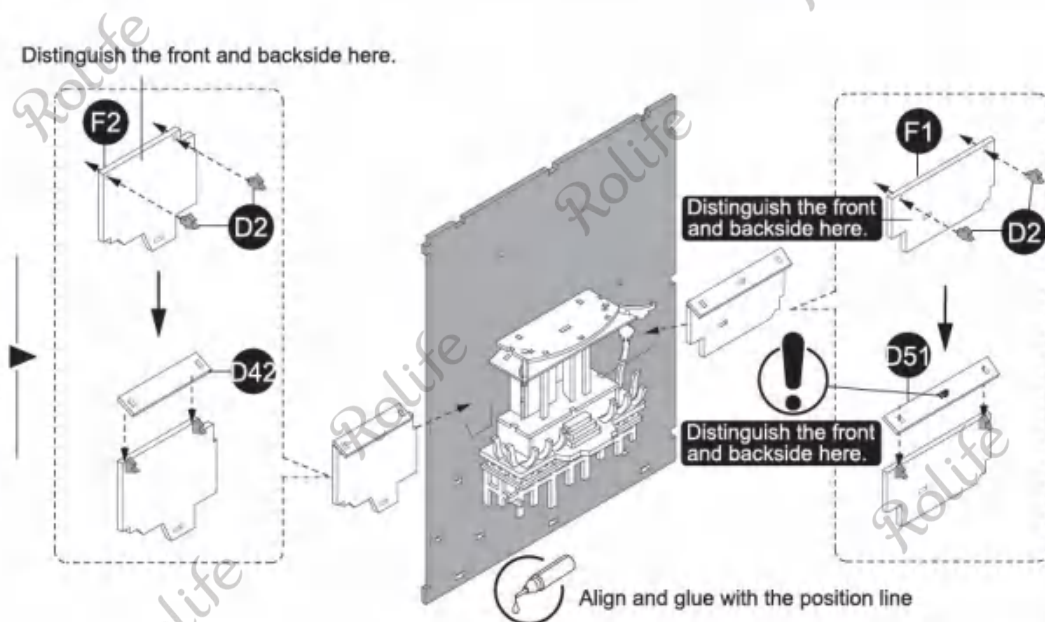
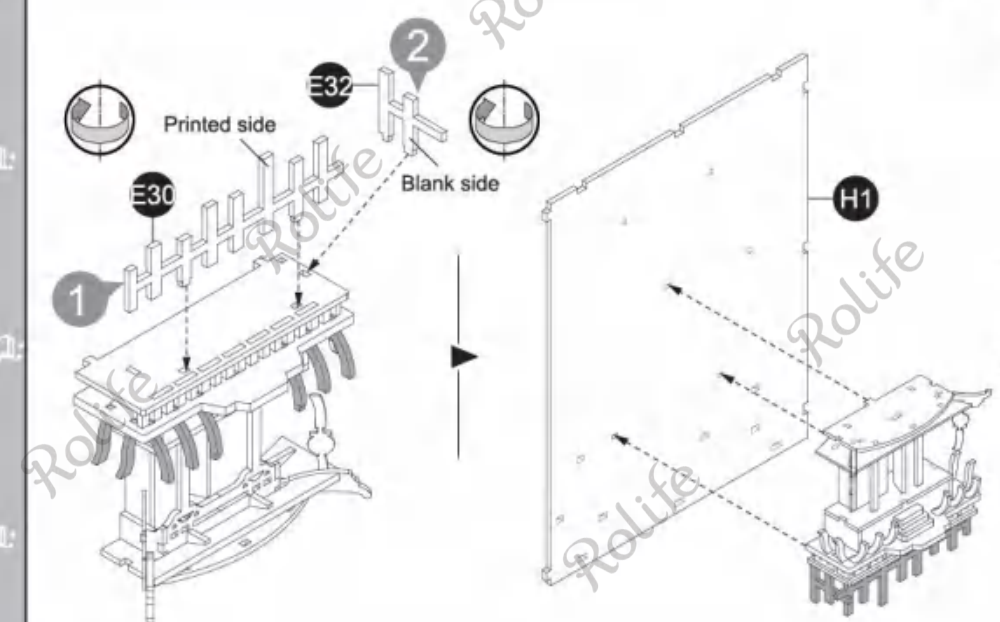
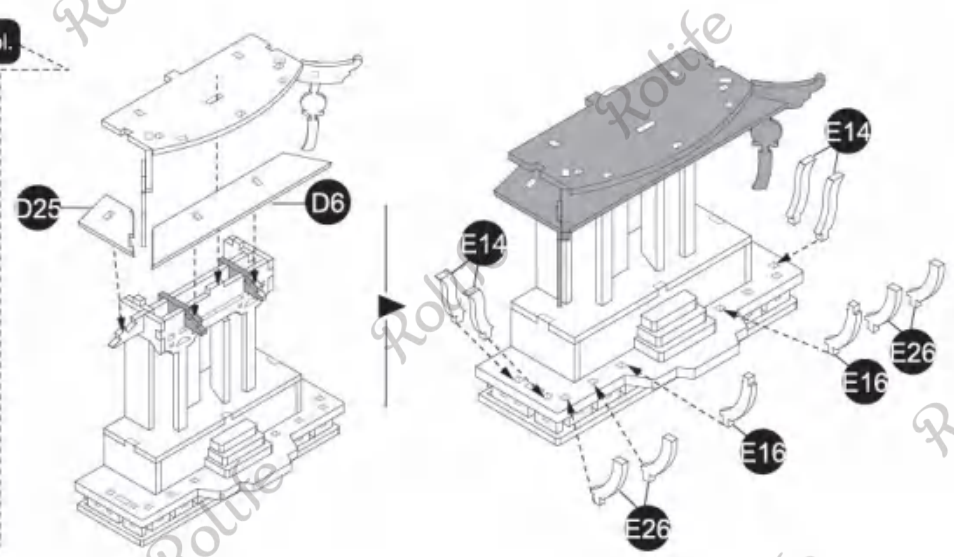
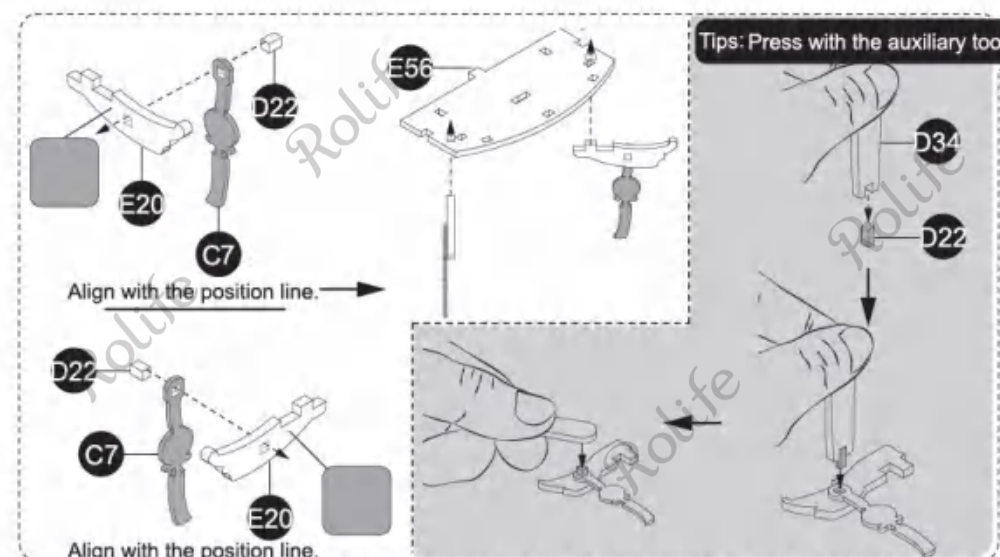

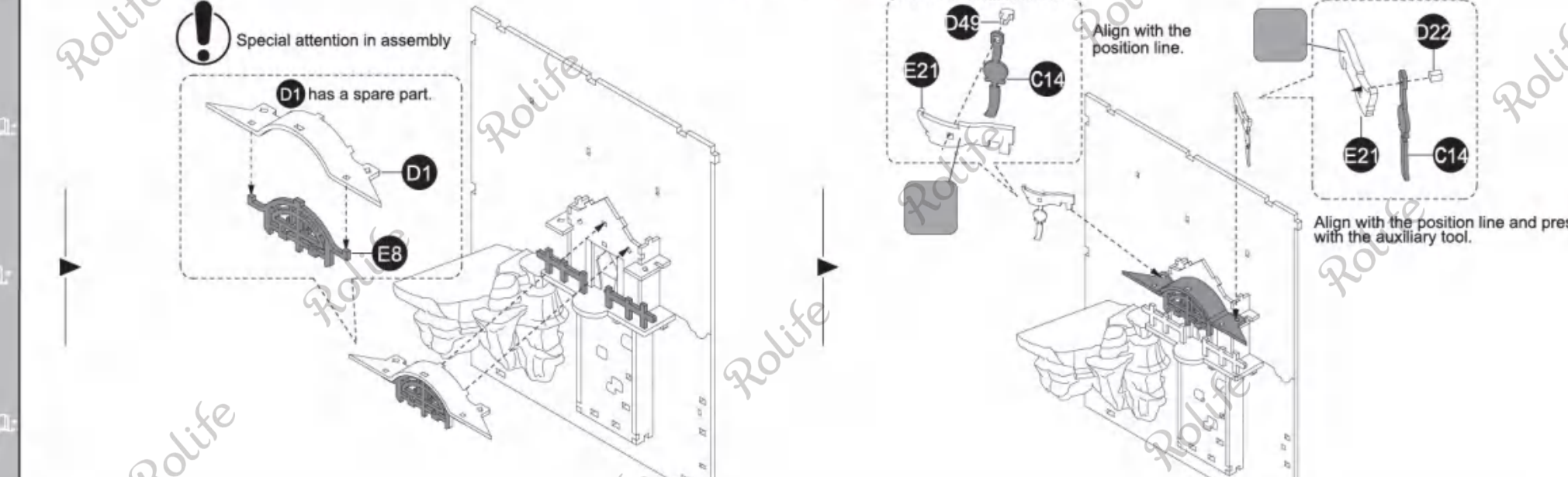
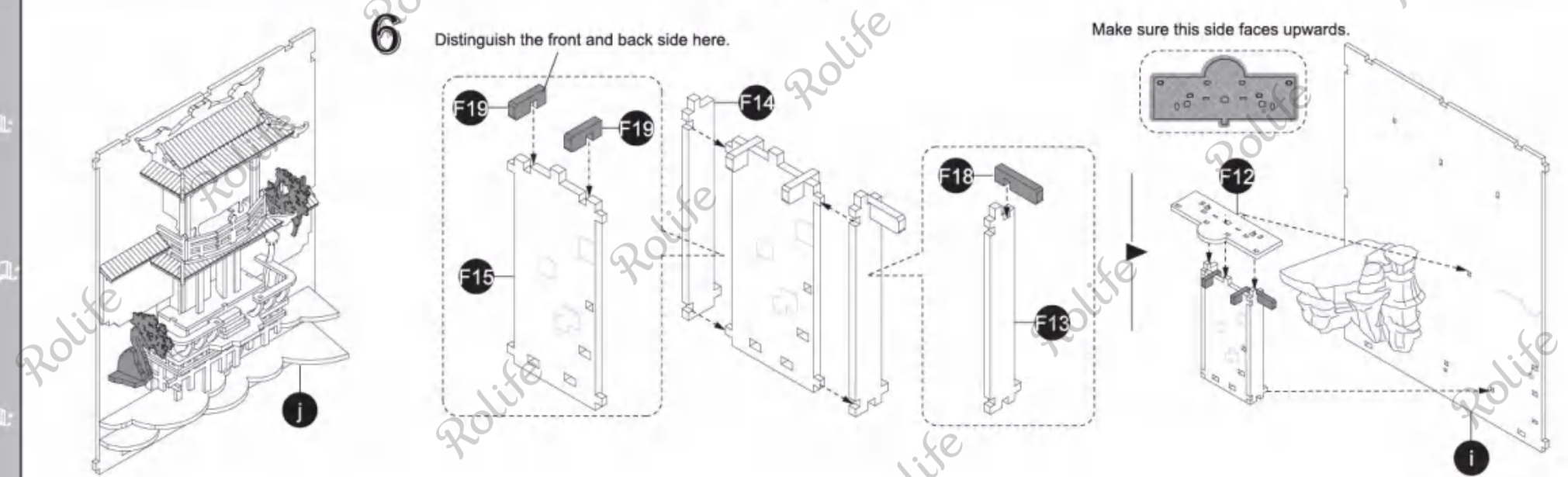
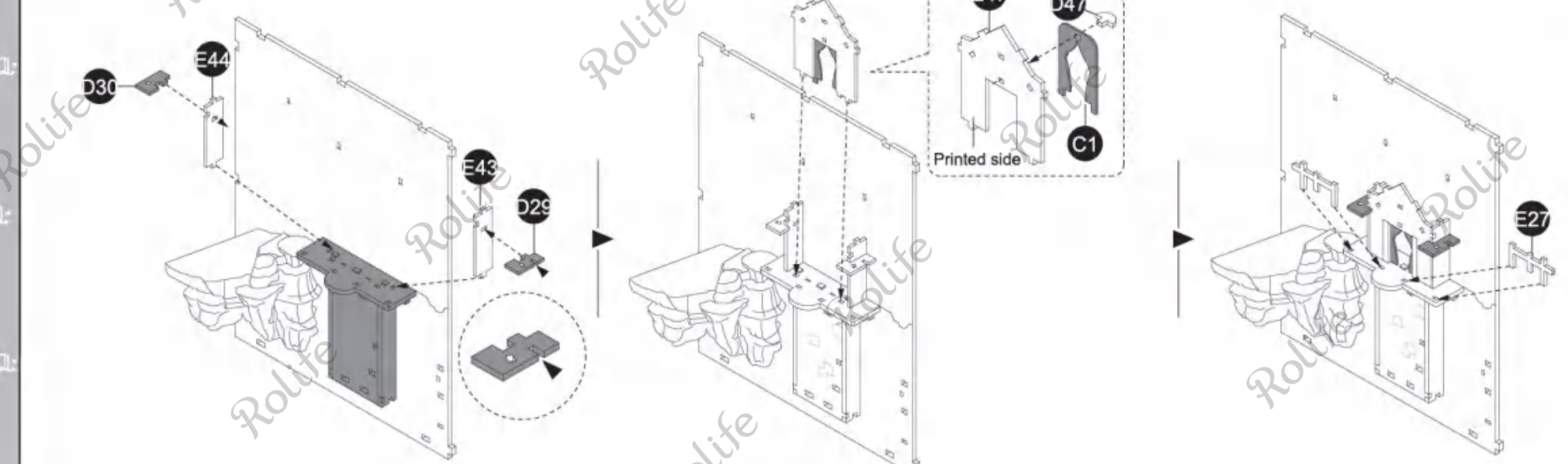
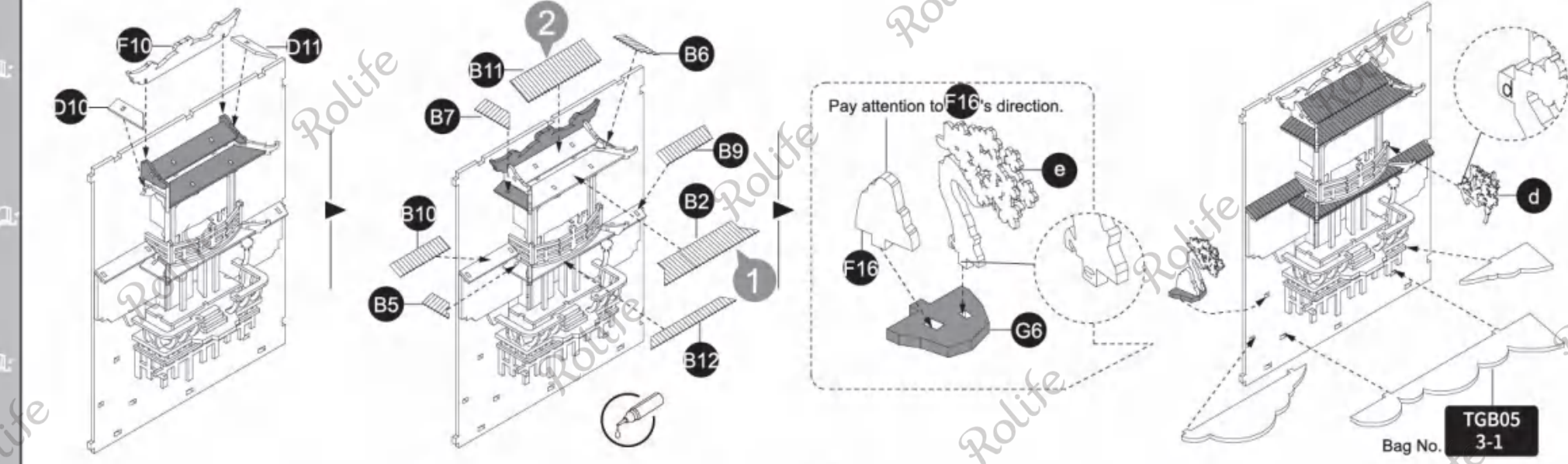

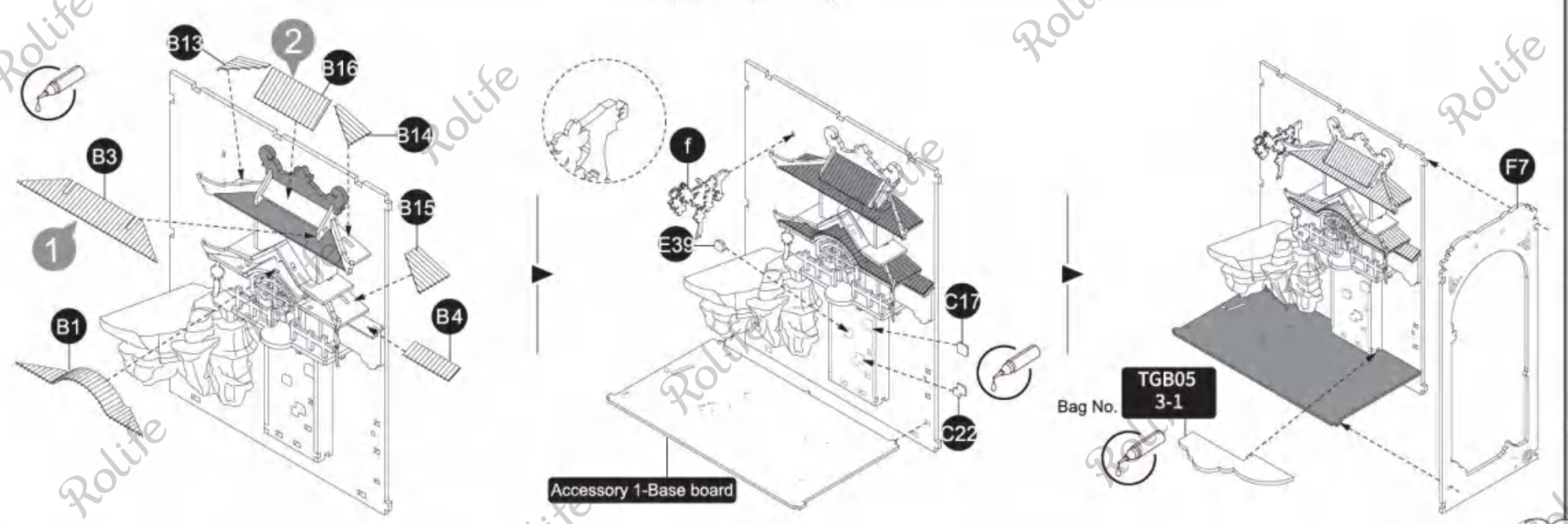
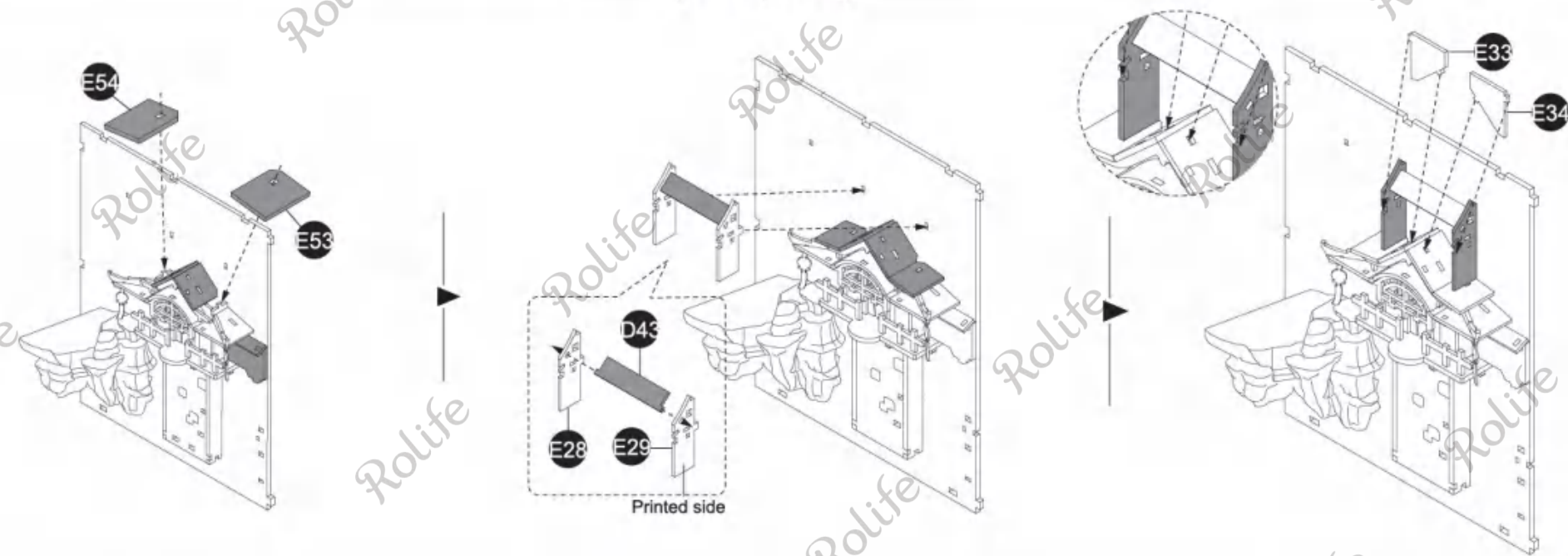
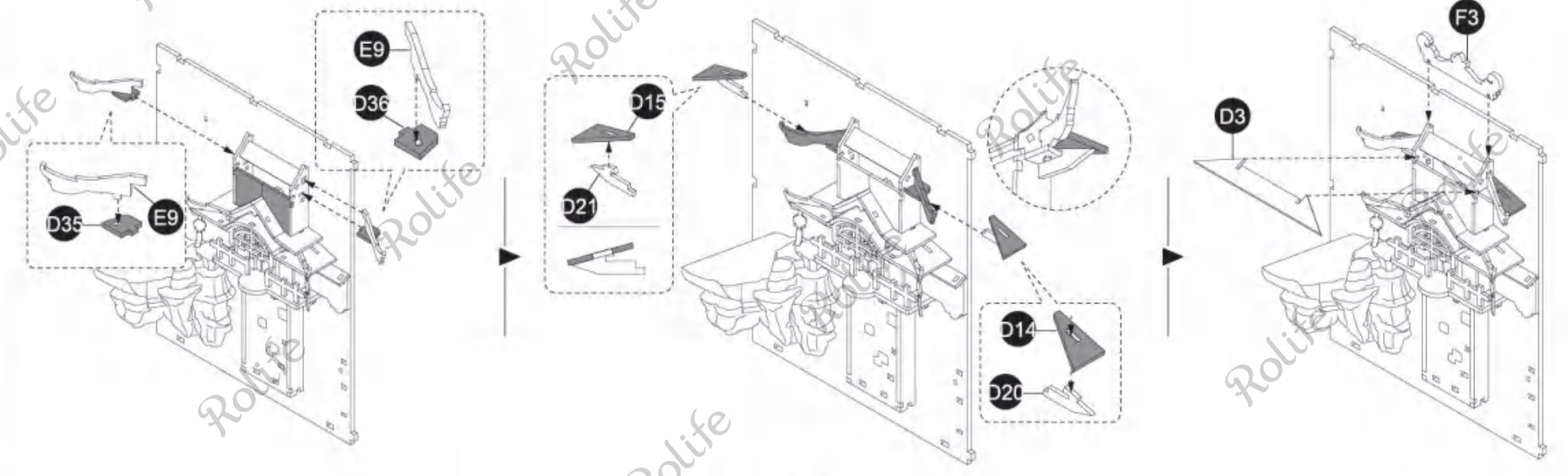
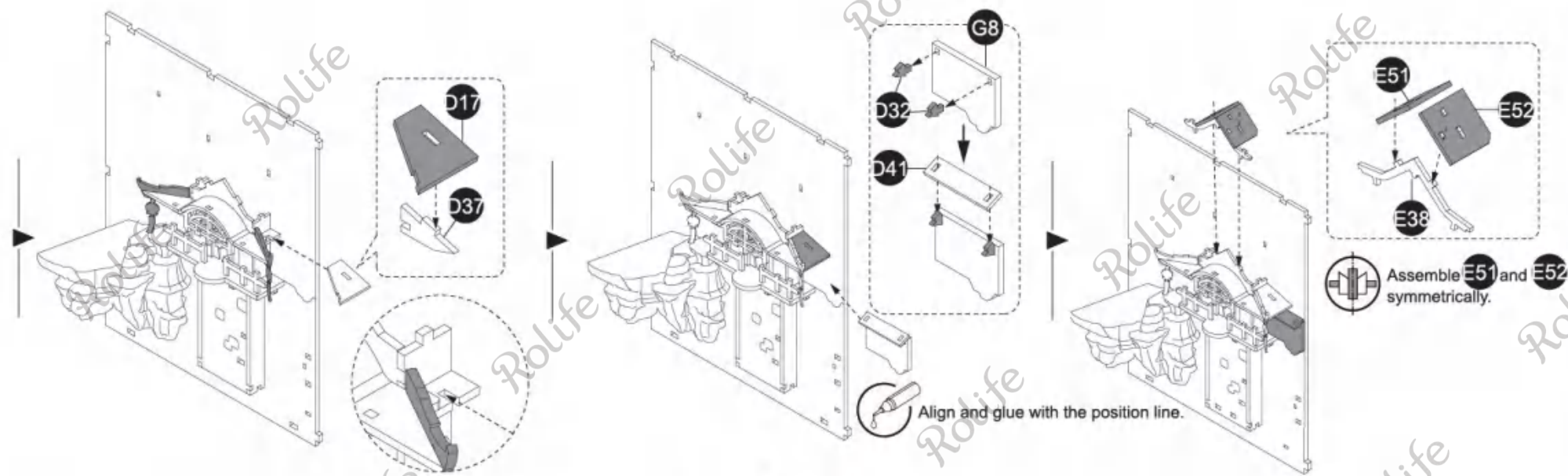

Accessories can be found in the white blister box in the package.

Align and glue C19, C13, C20 with the round patterns.

Bag No. TGB05 3-1

Bag No. TGB05 3-1

13

7

G2

k

D13

D24

C21

D16

C16

D12

C18

8

F8

E35

G5

F9

I

14

Distinguish the front and back side here.

D50

D33

D7

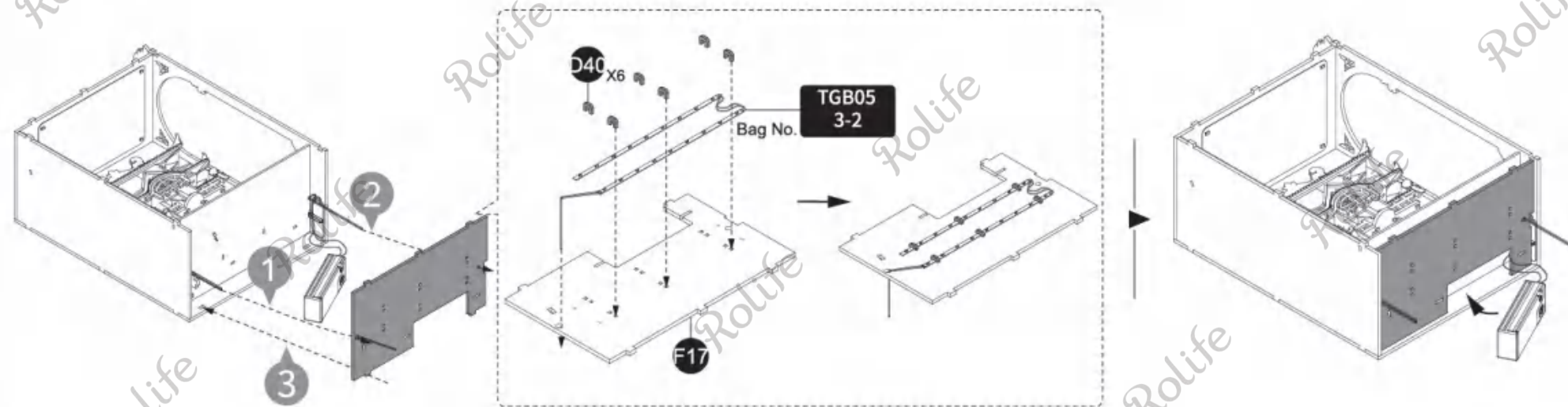
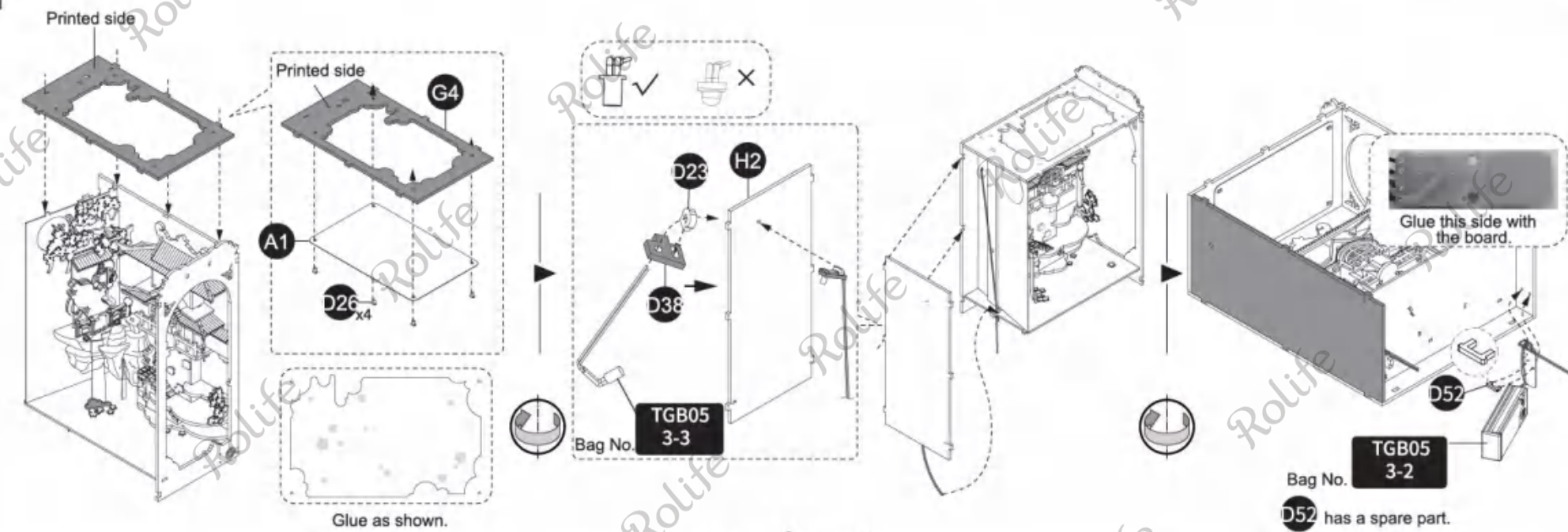
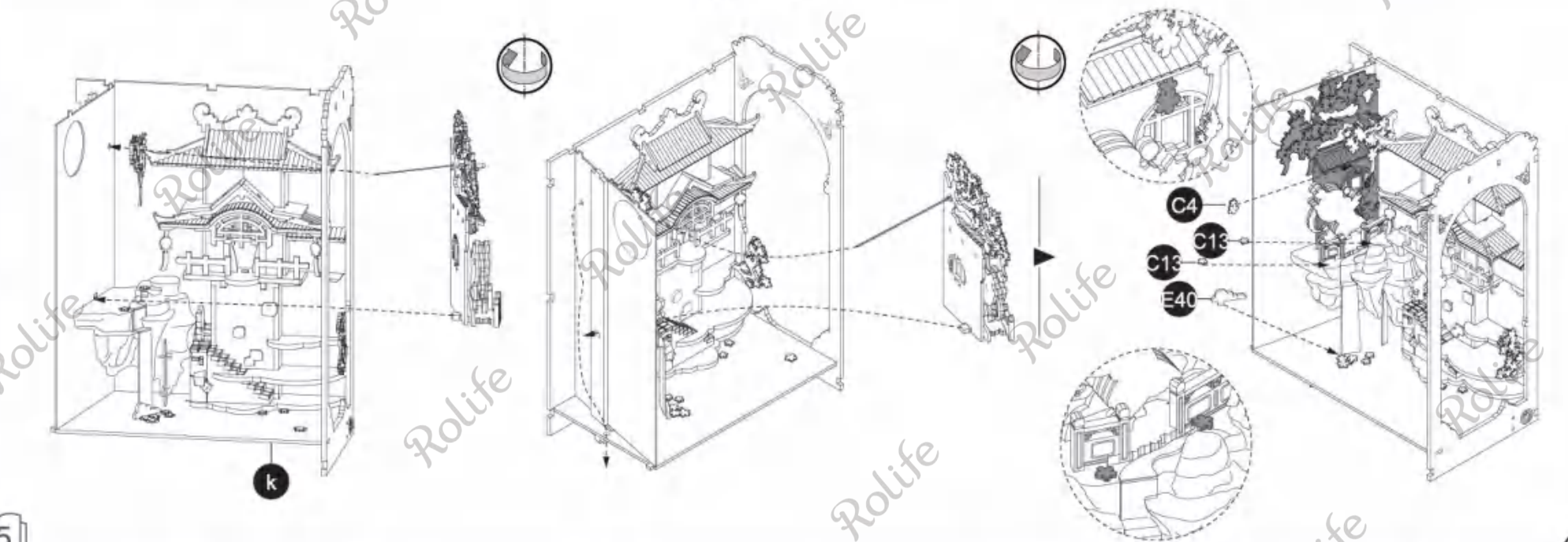
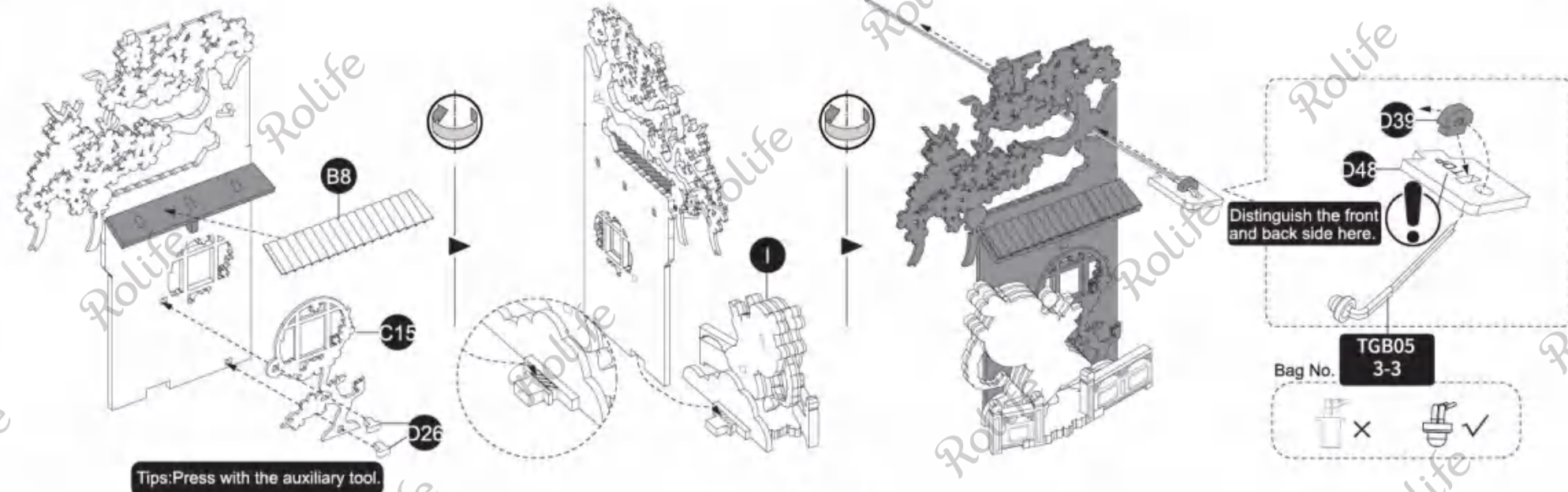

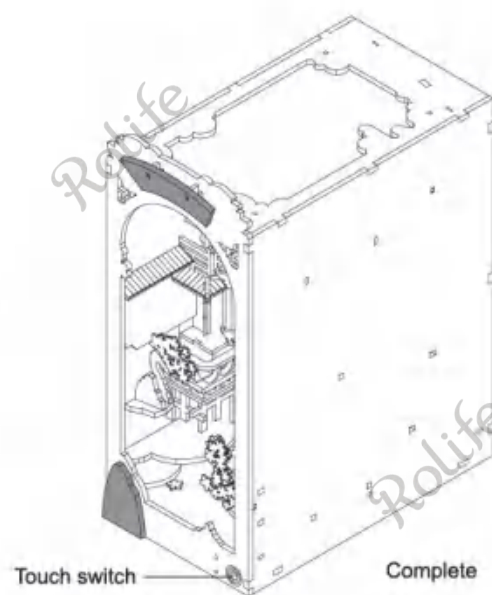
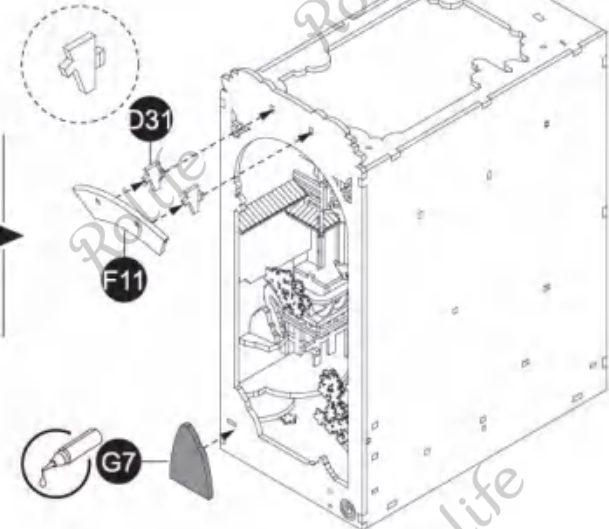
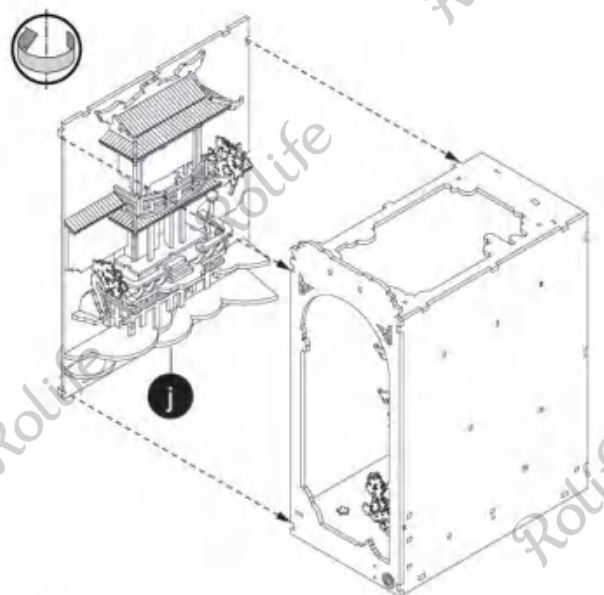
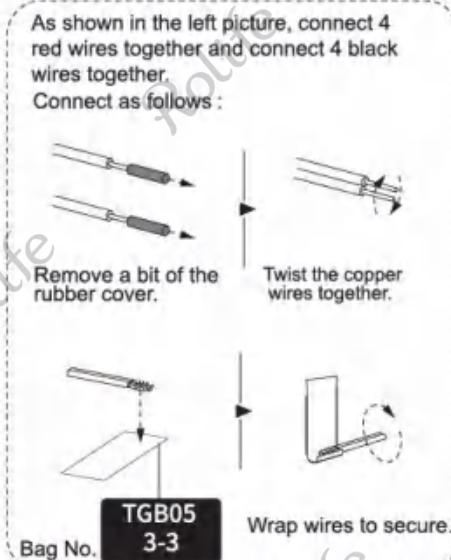
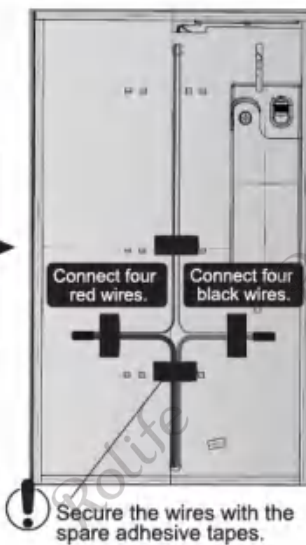
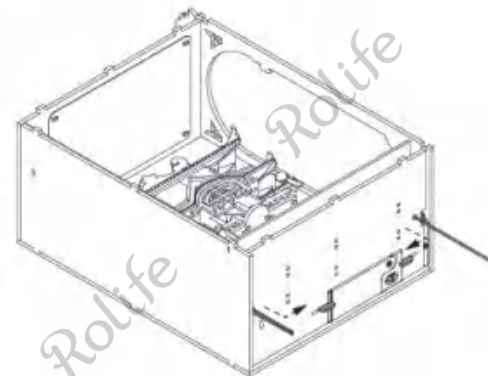
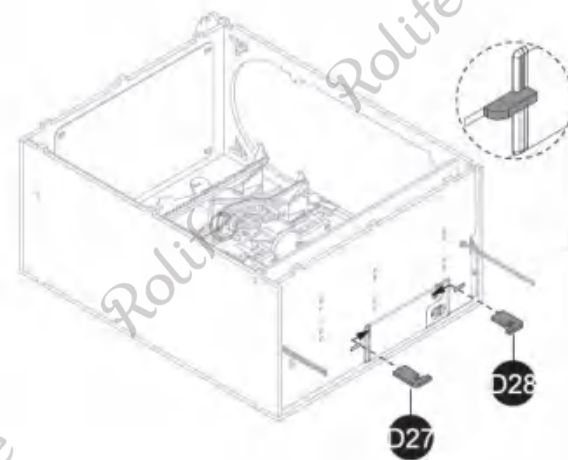

**BOOK NOOK
& WONDERLAND**

**FALLING
SAKURA**
-TGB05-



ROLIFE Facebook



rolife.robotime.com/



TGB01
Sakura Densya



TGB02
Sunshine Town



TGB03
Magic House



TGB04
Time Travel



TGB05
Falling Sakura