



WARNING:

- The instruction includes important information and please keep it well for future reference.

MAINTENANCE:

- Keep the product away from the source of ignition and water to prevent any damage.
- Don't use chemical reagents like alcohol and ammonia water to clean the product.
- Use clean and soft fabric to clean the product if necessary.

Part list	
Item	Invisible Tape
Part number	C1
Illustration	
Quantity	10



ROKR Facebook

store.robotime.com

Printed side Blank side Perspective changed Complete 2 same parts Special attention in assembly Step 1 Step 2

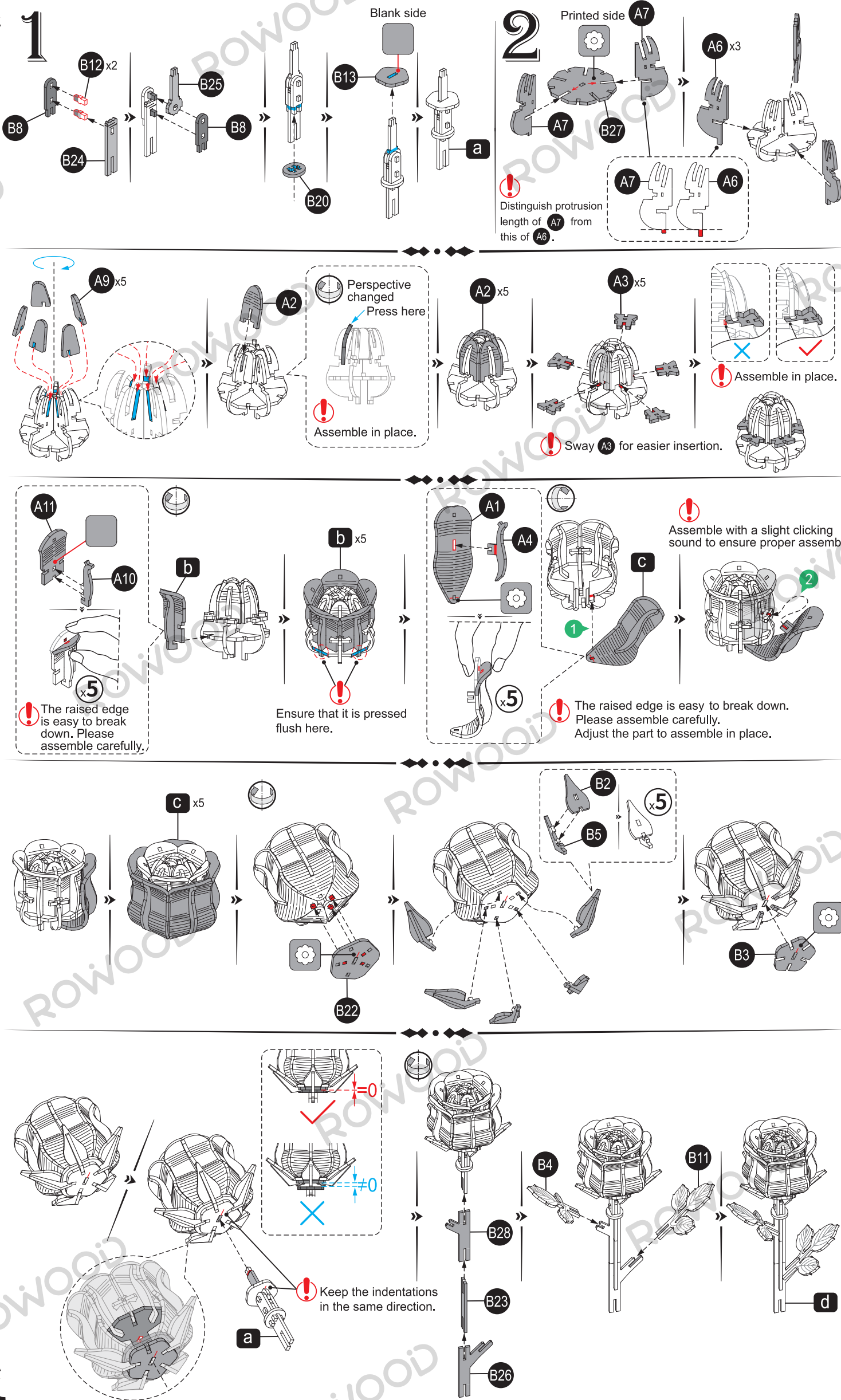

3

